

| | | | |
|--------------------------------|---|---------------------|------------|
| WPCLF Bid Specification |  Defiance County General Health District 1300 East Second Street, Suite 100, Defiance, Ohio 43512 Phone 419-784-3818 Fax 419-782-4979 | Loan Year Ending | |
| | | Nov 30, 2017 | |
| Date posted 04/18/2017 | Date Received | Date awarded | Sanitarian |

| | | | |
|-------------------------|------------------------------|--------|---------------|
| Name of Grant Applicant | Address | | Township |
| | State Route 18, Sherwood, OH | | Delaware |
| Home Phone | Cell Phone | e-mail | Funding level |
| | | | 100% |

Bid request for: Design Stage Installation Phase Both

| Item # | Activity | Specification | Quantity | Cost |
|--------|------------------------------|---|--------------|--------|
| 1 | Site Preparation | Remove one large tree and 2 smaller trees. | | |
| 2 | Septic Tank | 1500 gallon, 2 compartment septic tank, backfill, filter, and risers to grade. | | |
| 3 | Lift station | 500 gallon lift station, riser, pump and electrical to breaker box. Pressurized pipe and D-Box with flow equalization & velocity reduction. | | |
| 4 | Sand fill | 2-sand beds 8 feet wide, 77 feet long and 1 foot deep installed on contour. Depth to restrictive layer was 8 inches. | | |
| 5 | Treatment system | 2-Presby beds, each containing 2-75 foot runs of Presby AES (300' total), vent pipes and inspection ports. | tons | |
| 6 | Perimeter drain | 6 inch drain trenched to a depth of 18 inches on upslope of beds, and backfilled to within 6 inches of surface with coarse gravel. | | |
| 7 | Cover material | Soil to cover mounds, grass seed and straw. | | |
| 8 | Abandonment | Pump 1500 g septic tank and collapse | | |
| 10 | Eligible Miscellaneous Costs | | | |
| | Installation Permit | Installation Permit | 1 | 350.00 |
| | | | Total | |

Costs ineligible for funding: Sales tax, administrative costs, contractor registration fees, insurance costs, performance bond costs, abandonment of water wells, connecting home to public sewer system, sewage systems for new homes.

Eligible costs: Connections or reconnections outside home, indoor plumbing*, pumping and demolition of failing HSTS, design costs, health district installation permit fees, cost of soil scientist/evaluator, NPDES Permit fees, Site and Soil Survey, removal of trees, removal of vegetation. *Plumbing (sewer) connections must be itemized and be necessary for health district approval of the system.

 Installer _____ Date _____ Phone

Ohio law requires that underground utilities be located prior to excavation. Contact the OHIO UTILITIES PROTECTION SERVICE at 811 or 1-800-362-2764

SR 18

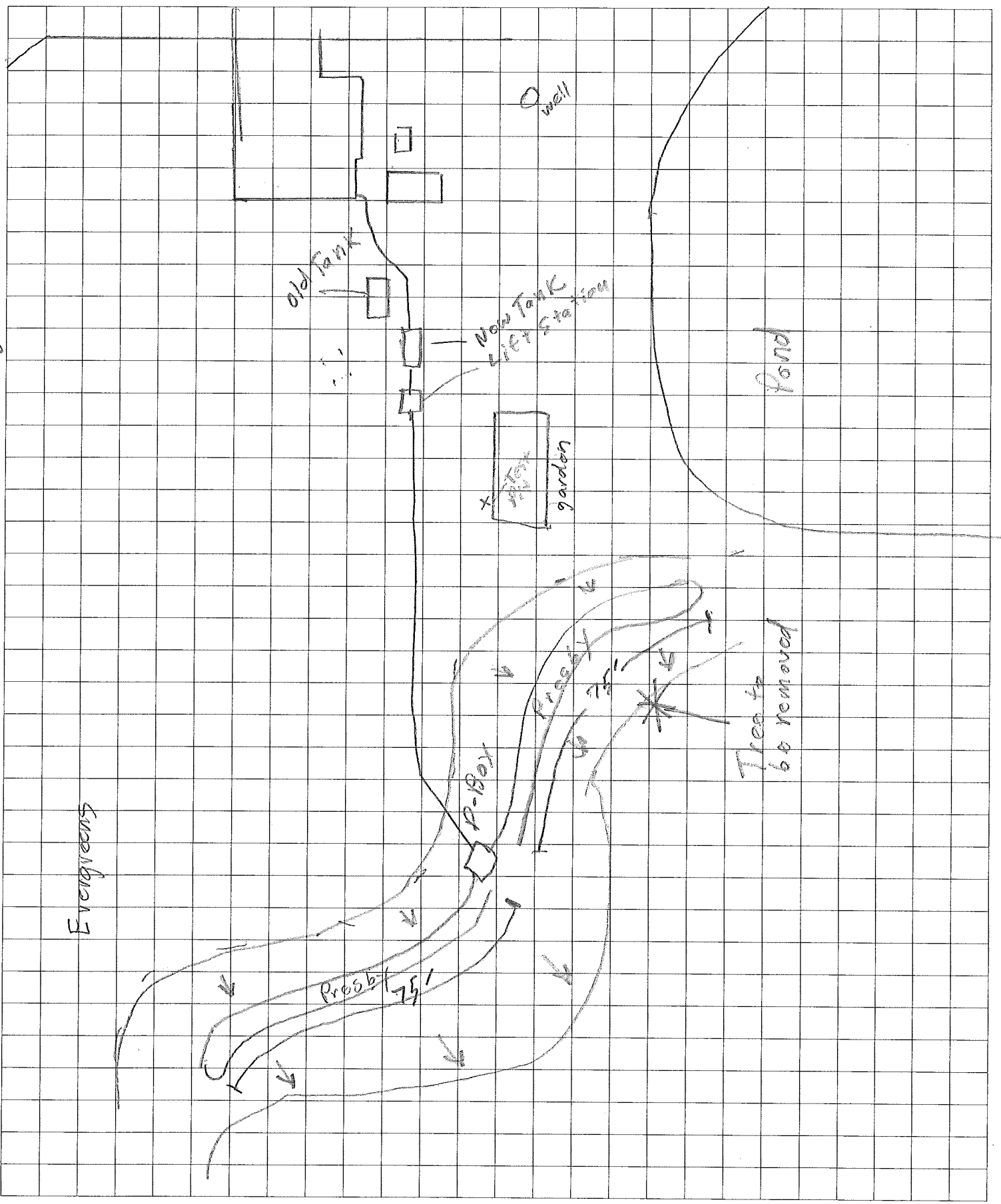

Evergreens

old Tank

New Tank
Lift Station

New Tank
garden

well

Pond

P-Box

Prosby
751

Prosby
752

Trees to
be removed